

通过使用2个滑动膜来增加拓展长度

i ⁷⁸⁾ 以igus® 测试方法为依据 ▶ 页码 1146
⁸⁵⁾ 安装2个JSM-0810-16
请注意: 安装说明 ▶ 页码 1079

尺寸 [mm]

d1	d2 h7	d3	dt	B	Bf	ts	db	ds	产品代码
8.0	16	32	24	45	8	3.1	3.5	6.0	FJZMT-01-08 ⁸⁵⁾
10.0	19	39	29	52	9	4.1	4.5	7.5	FJUMT-01-10
10.4	19	39	29	52	9	4.1	4.5	7.5	FJUMT-01-10-LL
12.0	22	42	32	57	9	4.1	4.5	7.5	FJUMT-01-12
12.4	22	42	32	57	9	4.1	4.5	7.5	FJUMT-01-12-LL
16.0	26	46	36	70	9	4.1	4.5	7.5	FJUMT-01-16
16.4	26	46	36	70	9	4.1	4.5	7.5	FJUMT-01-16-LL
20.0	32	54	43	80	11	5.1	5.5	9.0	FJUMT-01-20
20.5	32	54	43	80	11	5.1	5.5	9.0	FJUMT-01-20-LL
25.0	40	62	51	112	11	5.1	5.5	9.0	FJUMT-01-25
25.5	40	62	51	112	11	5.1	5.5	9.0	FJUMT-01-25-LL
30.0	47	76	62	123	14	6.1	6.6	11.0	FJUMT-01-30
30.6	47	76	62	123	14	6.1	6.6	11.0	FJUMT-01-30-LL
40.0	62	98	80	151	18	8.1	9.0	14.0	FJUMT-01-40
50.0	75	112	94	192	18	8.1	9.0	14.0	FJUMT-01-50

可选drylin® 滑动膜(可选项: J200/A180):



订购代码

类型

尺寸

F J U M T-01-10-LL



选项:
LL: 浮动式轴承

技术数据

产品代码	标准直径尺寸	d1-公差 ⁷⁸⁾	导轨长度	轴承表面 可承受载荷	重量
	[mm]	[mm]	[mm]	[N]	[g]
FJZMT-01-08 ⁸⁵⁾	8	+0.032 +0.070	45	256	27.13
FJUMT-01-10	10	+0.030 +0.088	52	250	43.75
FJUMT-01-10-LL	10	+0.030 +0.088	52	250	43.75
FJUMT-01-12	12	+0.030 +0.088	57	324	57.00
FJUMT-01-12-LL	12	+0.030 +0.088	57	324	57.00
FJUMT-01-16	16	+0.030 +0.088	70	464	78.28
FJUMT-01-16-LL	16	+0.030 +0.088	70	464	78.28
FJUMT-01-20	20	+0.030 +0.091	80	580	126.42
FJUMT-01-20-LL	20	+0.030 +0.091	80	580	126.42
FJUMT-01-25	25	+0.030 +0.091	112	975	248.85
FJUMT-01-25-LL	25	+0.030 +0.091	112	975	248.85
FJUMT-01-30	30	+0.040 +0.110	123	1,470	388.37
FJUMT-01-30-LL	30	+0.040 +0.110	123	1,470	388.37
FJUMT-01-40	40	+0.040 +0.115	151	2,360	835.00
FJUMT-01-50	50	+0.050 +0.150	192	3,450	1,352.30

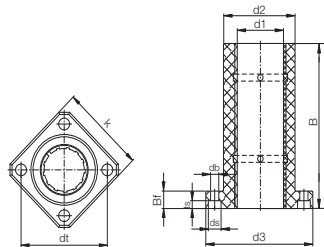

通过使用2个滑动膜来增加拓展长度

i ⁷⁸⁾ 以igus® 测试方法为依据 ▶ 页码1146
⁸⁵⁾ 安装2个JSM-0810-16
请注意: 安装说明 ▶ 页码 1079

尺寸 [mm]

d1	d2 h7	d3	dt	k	B	Bf	ts	db	ds	产品代码
8.0	16	32	24	25	45	8	3.1	3.5	6.0	FJZMT-02-08 ⁸⁵⁾
10.0	19	39	29	30	52	9	4.1	4.5	7.5	FJUMT-02-10
10.4	19	39	29	30	52	9	4.1	4.5	7.5	FJUMT-02-10-LL
12.0	22	42	32	32	57	9	4.1	4.5	7.5	FJUMT-02-12
12.4	22	42	32	32	57	9	4.1	4.5	7.5	FJUMT-02-12-LL
16.0	26	46	36	35	70	9	4.1	4.5	7.5	FJUMT-02-16
16.4	26	46	36	35	70	9	4.1	4.5	7.5	FJUMT-02-16-LL
20.0	32	54	43	42	80	11	5.1	5.5	9.0	FJUMT-02-20
20.5	32	54	43	42	80	11	5.1	5.5	9.0	FJUMT-02-20-LL
25.0	40	62	51	50	112	11	5.1	5.5	9.0	FJUMT-02-25
25.5	40	62	51	50	112	11	5.1	5.5	9.0	FJUMT-02-25-LL
30.0	47	76	62	60	123	14	6.1	6.6	11.0	FJUMT-02-30
30.6	47	76	62	60	123	14	6.1	6.6	11.0	FJUMT-02-30-LL
40.0	62	98	80	75	151	18	8.1	9.0	14.0	FJUMT-02-40
50.0	75	112	94	88	192	18	8.1	9.0	14.0	FJUMT-02-50

可选drylin® 滑动膜(可选项: J200/A180):



J E7 X

🔑 订购代码

类型 尺寸

F J U M T-02-10-LL

带法兰
iglidur® J
滑动膜
公制
串联式
方法兰
内径- \varnothing d1

选项:
LL: 浮动式轴承

技术数据

产品代码	标准 直径尺寸 [mm]	d1-公差 ⁷⁸⁾ [mm]	导轨长度 [mm]	轴承表面 可承受载荷 [N]	重量 [g]
FJZMT-02-08 ⁸⁵⁾	8	+0.032 +0.070	45	256	23.00
FJUMT-02-10	10	+0.030 +0.088	52	250	36.58
FJUMT-02-10-LL	10	+0.030 +0.088	52	250	36.58
FJUMT-02-12	12	+0.030 +0.088	57	324	48.19
FJUMT-02-12-LL	12	+0.030 +0.088	57	324	48.19
FJUMT-02-16	16	+0.030 +0.088	70	464	67.79
FJUMT-02-16-LL	16	+0.030 +0.088	70	464	67.79
FJUMT-02-20	20	+0.030 +0.091	80	580	110.06
FJUMT-02-20-LL	20	+0.030 +0.091	80	580	110.06
FJUMT-02-25	25	+0.030 +0.091	112	975	230.06
FJUMT-02-25-LL	25	+0.030 +0.091	112	975	230.06
FJUMT-02-30	30	+0.040 +0.110	123	1,470	350.74
FJUMT-02-30-LL	30	+0.040 +0.110	123	1,470	350.74
FJUMT-02-40	40	+0.040 +0.115	151	2,360	739.30
FJUMT-02-50	50	+0.050 +0.150	192	3,450	1,249.30